

# RAVENNA/AES67 Network for Multiple Mastering Suites with a Shared Machine

## Description

This workflow example shows how best to connect 3 Pyramix suites to a single, shared machine room.

The Machine room contains all of the source machines (1/4" tape and other linear sources) that are controlled using the sync outputs of the Horus unit. The RAVENNA/AES67 streams pass from the Horus into the Gb LAN switch and can then be accessed by any of the suites. As the control for the line inputs, as well as the sync information for the Horus is over the same network connection as the RAVENNA/AES67 stream, it means that only one cable needs to go to the machine room.

Control over the Pyramix is made with a second network connection to the control surface.

Each DA8P line output card is connected to its own studio, providing discreet line outputs (5.1 Surround + Stereo) to each mastering suite)

It is also important to note that the RAVENNA /AES67 connection will also allow for signal to be easily and instantly shared from control to control room as well, as any interconnections is possible over the RAVENNA/AES67 network.

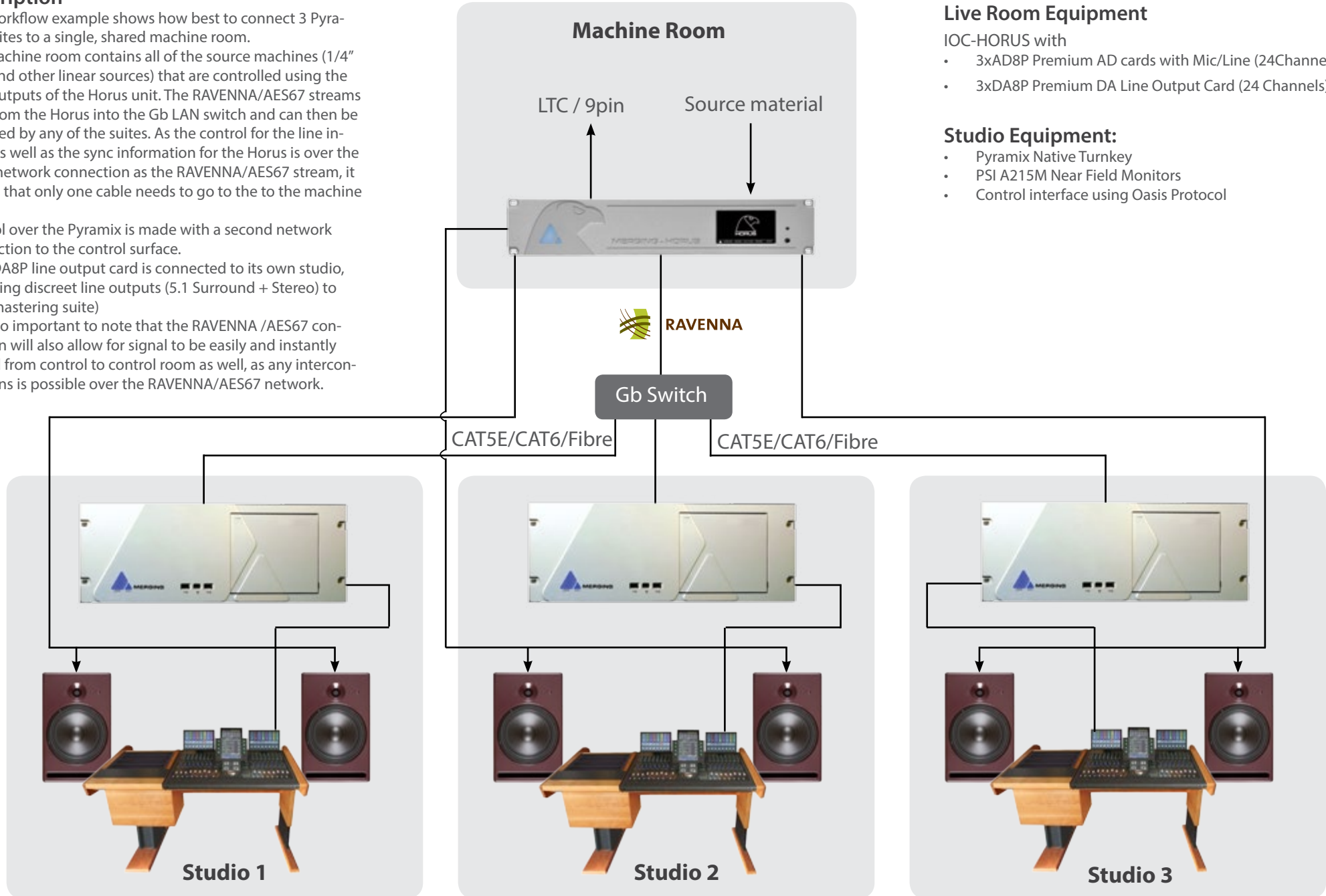

## Live Room Equipment

IOC-HORUS with

- 3xAD8P Premium AD cards with Mic/Line (24Channels)
- 3xDA8P Premium DA Line Output Card (24 Channels)

## Studio Equipment:

- Pyramix Native Turnkey
- PSI A215M Near Field Monitors
- Control interface using Oasis Protocol